



SPECIFICATIONS

- RATING** : 100mA max, 42 VAC/DC
- MECHANICAL LIFE** : 1,000,000 cycles
- CONTACT RESISTANCE** : 100mΩ max.(initial)
- INSULATION RESISTANCE** : 1000MΩ min.
- DIELECTRIC STRENGTH** : 1,000 VAC
- FORCE** : 3N±0.75N
- TRAVEL** : 0.6±0.2mm
- OPERATING TEMPERATURE RANG** : -25°C~+70°C

MATERIALS

- SWITCH HOUSING** : PBT
- TRANSPARENT ACTUATOR** : PC
- ACTUATOR** : ABS
- CONTACT** : Stainless,Au or Ag plated
- TERMINALS** : Brass,Au or Ag plated
- TERMINAL SEAL** : Epoxy



HOW TO ORDER

MODEL NO. SIZE TYPE CAP TYPE CAP COLOR LED Q'TY 1st SET LED COLOR (B,C Type Cap Only) 2nd SET LED COLOR (A Type Cap Only) CONTACT MATERIAL LED BRIGHTNESS

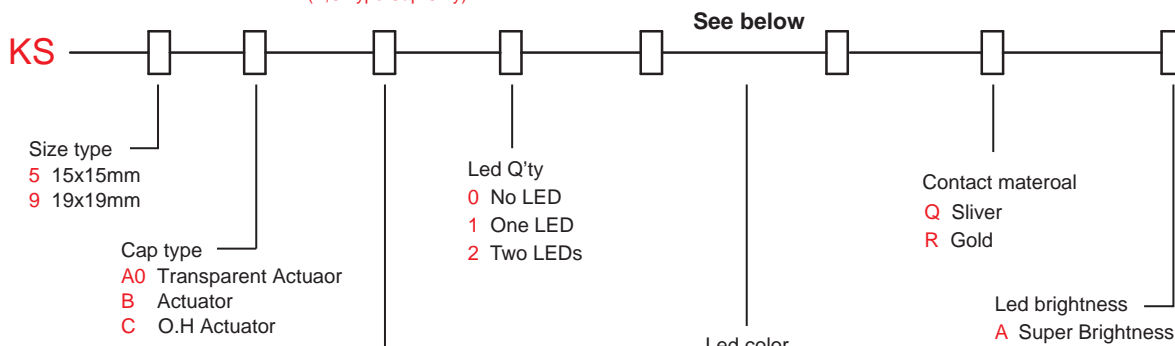

ITEM NO	COLOR
1	White (Std)
3	Red (Std)
4	Orange
5	Yellow
6	Green
7	Blue

ITEM NO	COLOR
0	Without LED
1	White
3	Red
5	Yellow
6	Green
7	Blue

* Besides standard color, other colors need to check stocks available.

P.C.B MOUNTING / CIRCUIT

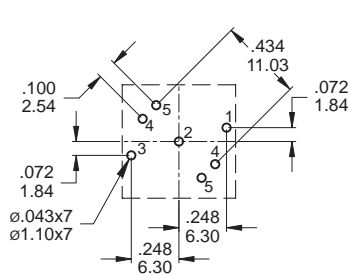

KS5A CAP Type
TOP VIEW

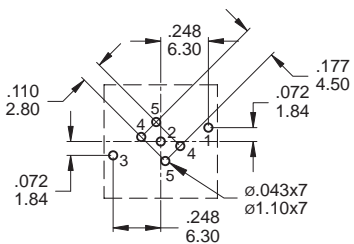

KS5B/C CAP Type
TOP VIEW

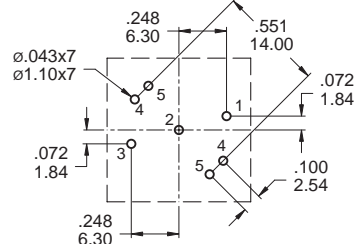

KS9A CAP Type
TOP VIEW

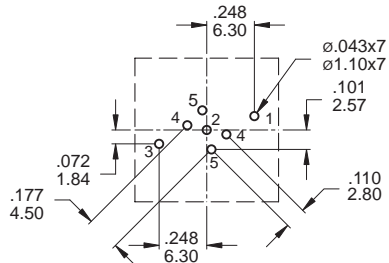

KS9B/C CAP Type
TOP VIEW

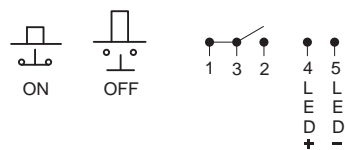

CIRCUIT

KS5A

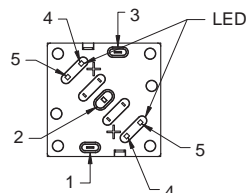
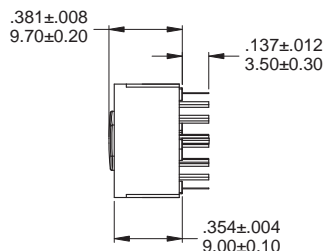
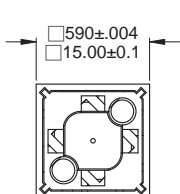

KS5B

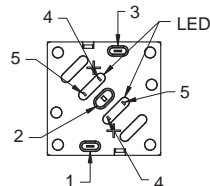
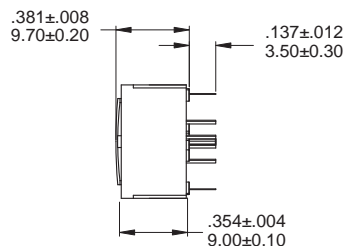
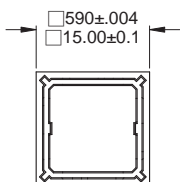

KS5C

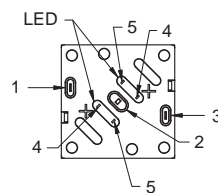
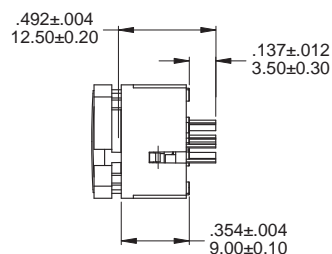
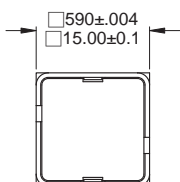

KS9A

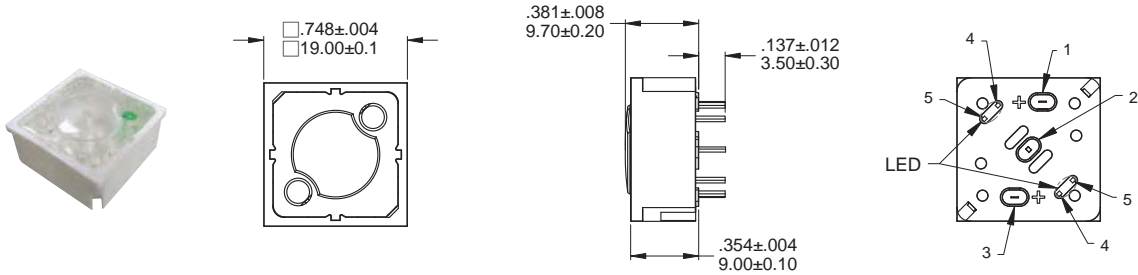

KS9B

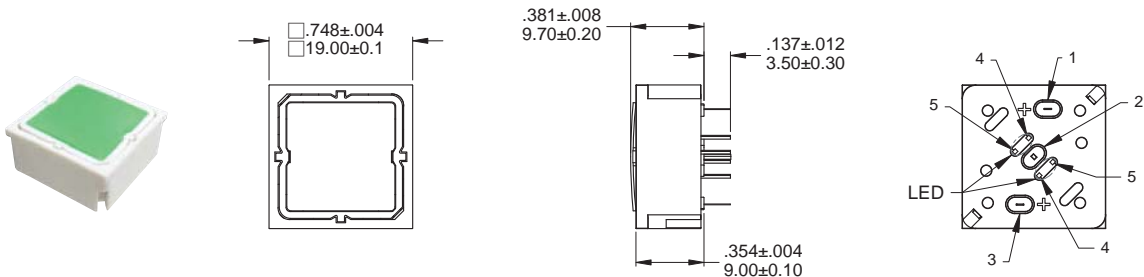

KS9C

