











T7

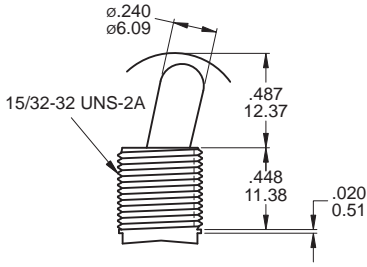

Use with B13 bushing  
Use with B18,B20 the lever is antirotation and the size of lever is 13.00mm

T8

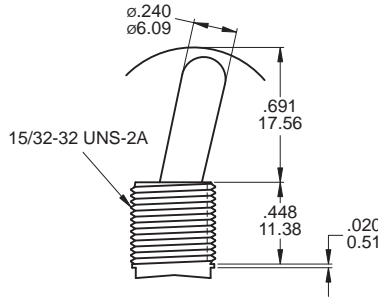

Use with B13 bushing  
Use with B18,B20 the lever is antirotation and the size of lever is 18.00mm

T9

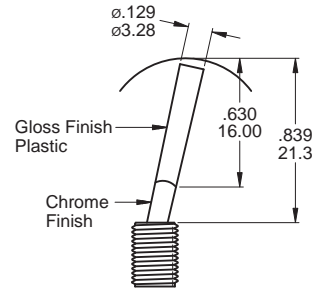

B1 / B2 bushing std  
with black and red color only ( std. )

TA PLASTIC BLACK

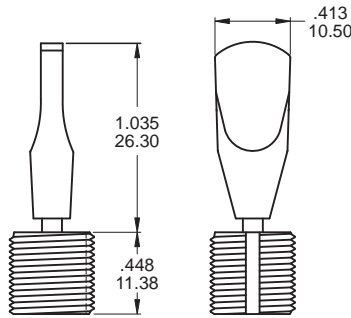

Use with B18 bushing only

T11

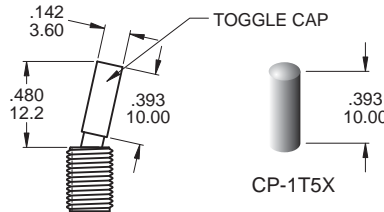

**NOTE** T11 Actuator shown with standard B1 Bushing ;  
Add .070 ( 1.78 ) for B3 Bushing ;  
Subtract .020 ( 0.51 ) for B6 Bushing.  
Std for M1.M2 Terminal sub .016 (0.40 ) for M6.M7.VSX

Plastic No.Color :

ITEM NO	COLOR
1	White
2	Black (Std)
3	Red
4	Orange
5	Yellow
6	Green
7	Blue
8	Brown
9	Gray

T62 , TA , T9 , T11  
ACTUATOR ONLY

TL1B25

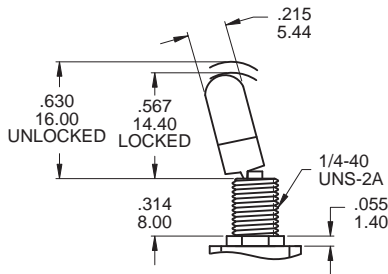

TL2B25

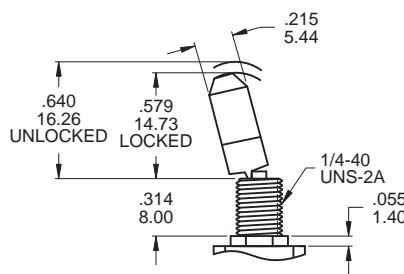

TL3B25

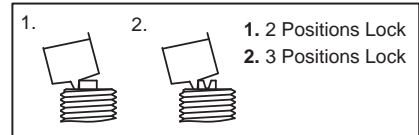
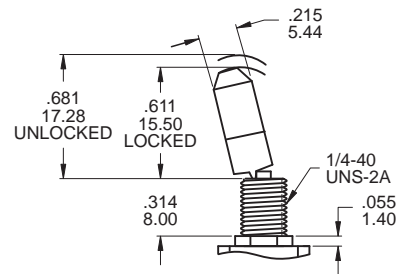

## BUSHING OPTIONS

B1 THD STD  
B2 NON-THD

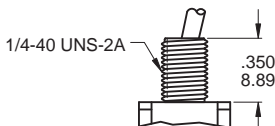
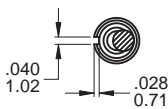

B3 THD  
B4 NON-THD

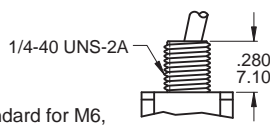
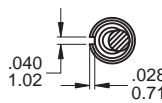

B4 is standard for M6,  
M7 and VS2-5 termination  
options.

B5 HIGH TORQUE

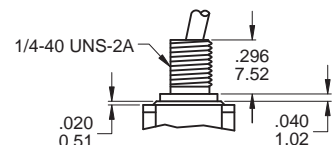
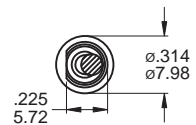

## B6 HIGH TORQUE

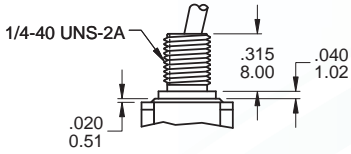
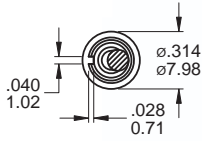

## B7 THD STD

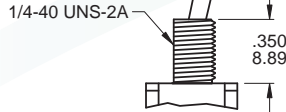
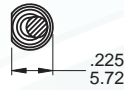

## B8 METRIC THD

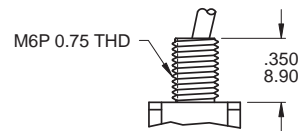
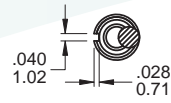

## B9 SPLASH PROOF

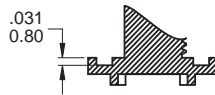
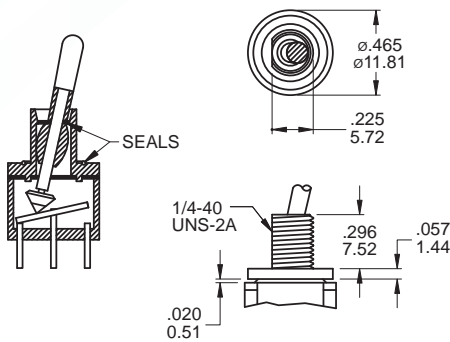

### CP-1TEB

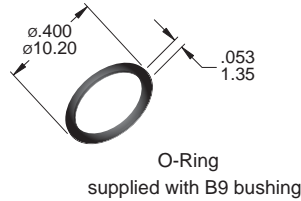

## B11 THD STD B12 NON-THD

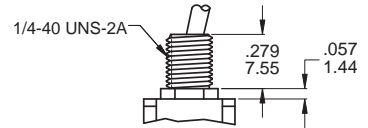
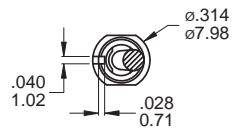

Use with T6 actuators only

## B15 THD STD B16 NON-THD

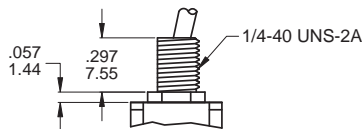
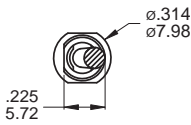

Use with T6 actuators only

## B17

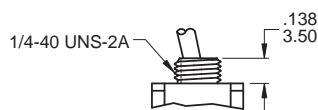
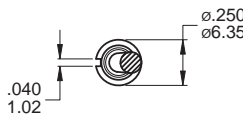

## B13

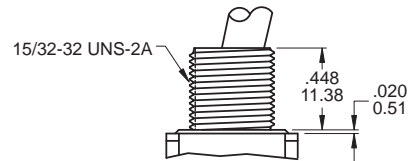
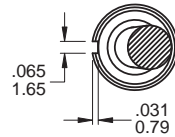

Use with T7, T8 actuators only  
B13 Bear strength from top of actuator up to 10kg aside up to 15kg

## B14 SPLASH PROOF

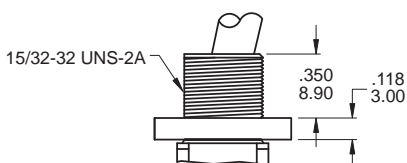
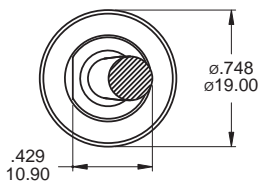

Use with T7, T8 actuators only

## B18

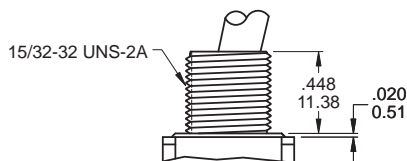
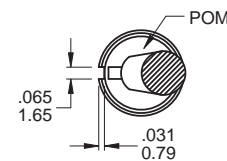

Use with T7, T8 and TA actuators only  
with Plastic (POM) Insert

## B20

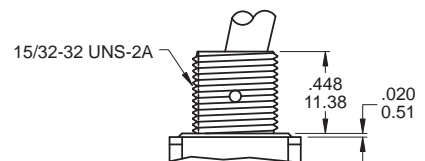
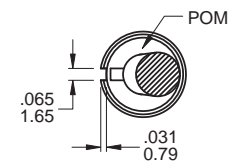

Use with T7, T8 and TA actuators only  
with Plastic (POM) Insert

B18, B20 Bear strength from top of actuator up to 20kg aside up to 15kg

## PANEL MOUNTING

### 1/4 IN BUSHING

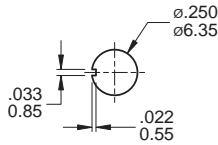

Without locking ring (Keyway)

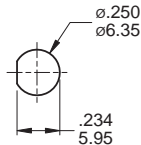

Without locking ring (Flat)

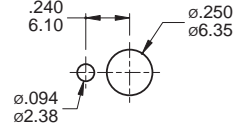

With standard locking ring.

### METRIC BUSHING

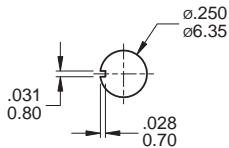

Without locking ring (Keyway)

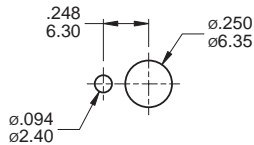

With standard locking ring.

### 15/32 IN BUSHING

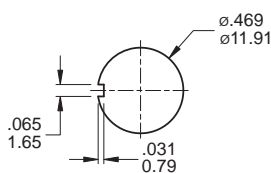

Without locking ring (Keyway)

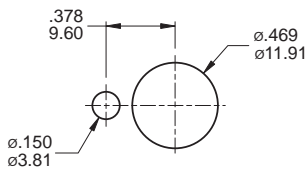

With standard locking ring.

### SPLASH PROOF BUSHING

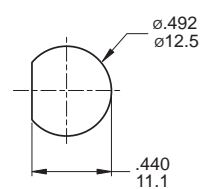

Without locking ring (Flat)

## TERMINATION OPTIONS

### M1 Solder lug

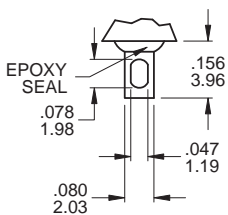

.030(0.76) THK.

### M2 PC Thru-hole

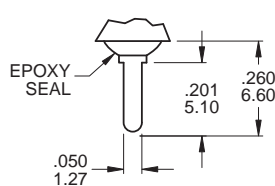

.030(0.76) THK.

### M3 Quick connect

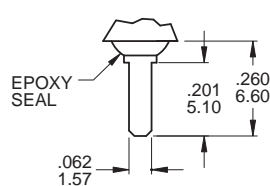

.030(0.76) THK.

### M5 Wire Wrap

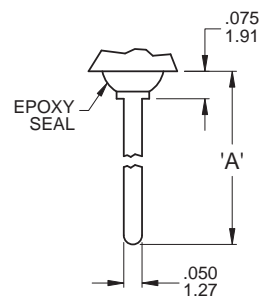

.030(0.76) THK.

## OTHER TERMINATION OPTIONS

- M6** RIGHT ANGLE P.C. MOUNT
- M7** RIGHT ANGLE P.C. MOUNT
- VS2** VERTICAL BRACKET P.C. MOUNT
- VS3** VERTICAL BRACKET P.C. MOUNT
- VS5** VERTICAL BRACKET P.C. MOUNT

OPTION CODE	DIM. 'A'
M5-1	.736 (18.70)
M5-2	.953 (24.20)
M5-3	.415 (10.55)
M5-4	1.062 (26.97)



## M6



1M  
Toggle Switches

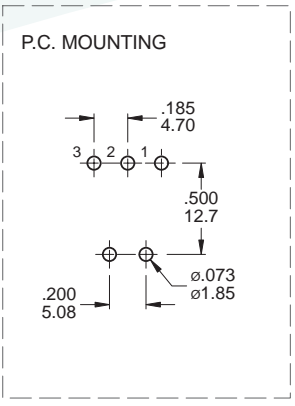
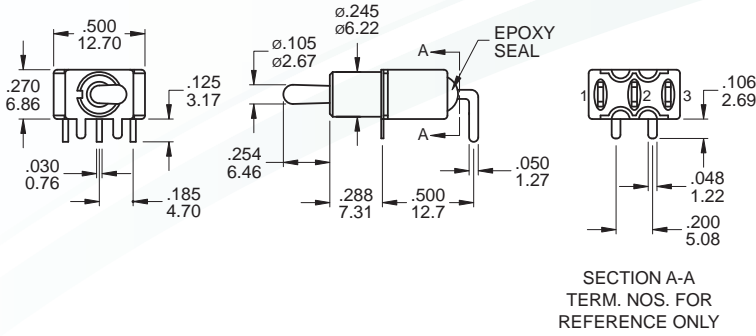

## SPDT

Part No. Shown : 1MS1T2B4M6QE

## M6

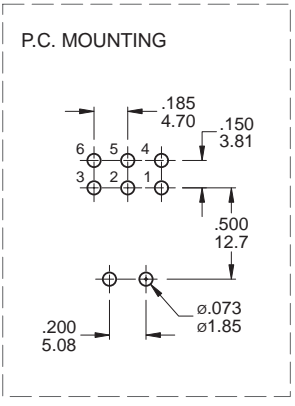
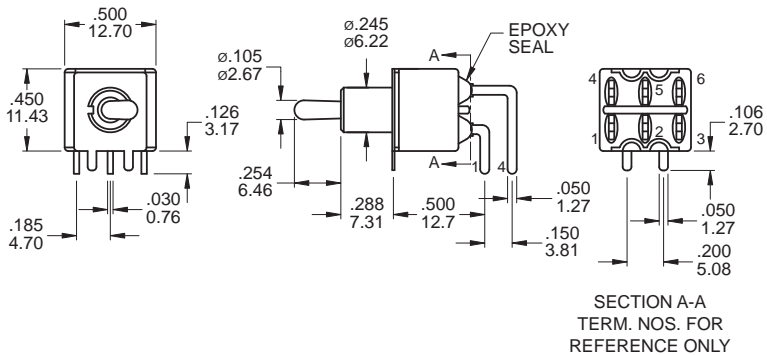

## DPDT

Part No. Shown : 1MD1T2B4M6RE

## M7

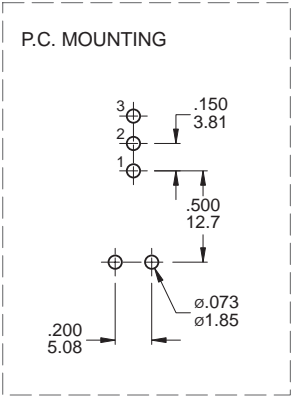
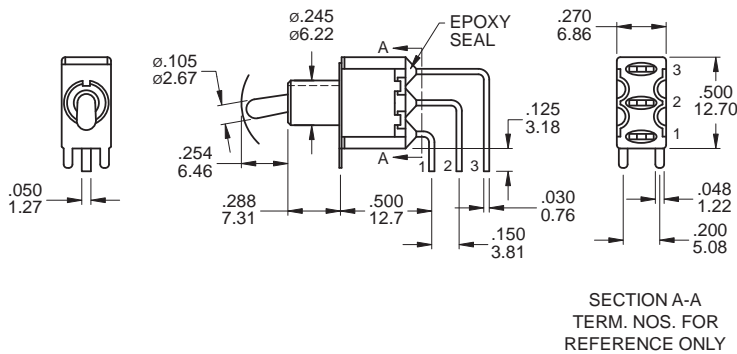

## SPDT

Part No. Shown : 1MS1T2B4M7QE

## M7

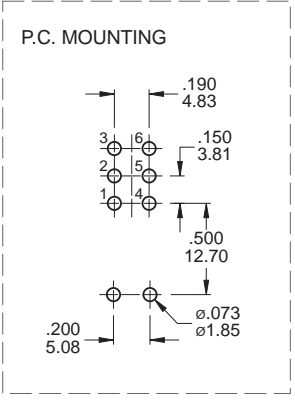
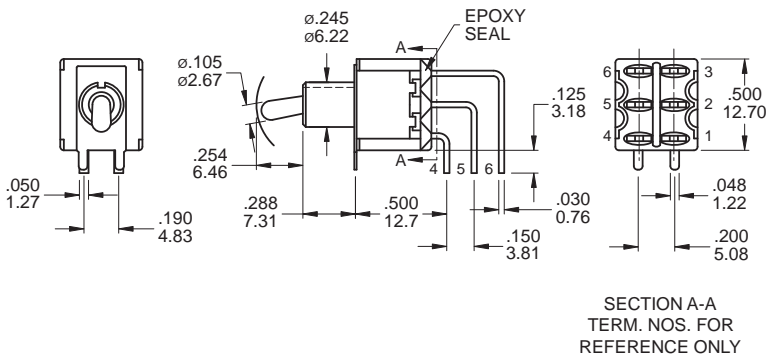

## DPDT

Part No. Shown : 1MD1T2B4M7QE



## M7

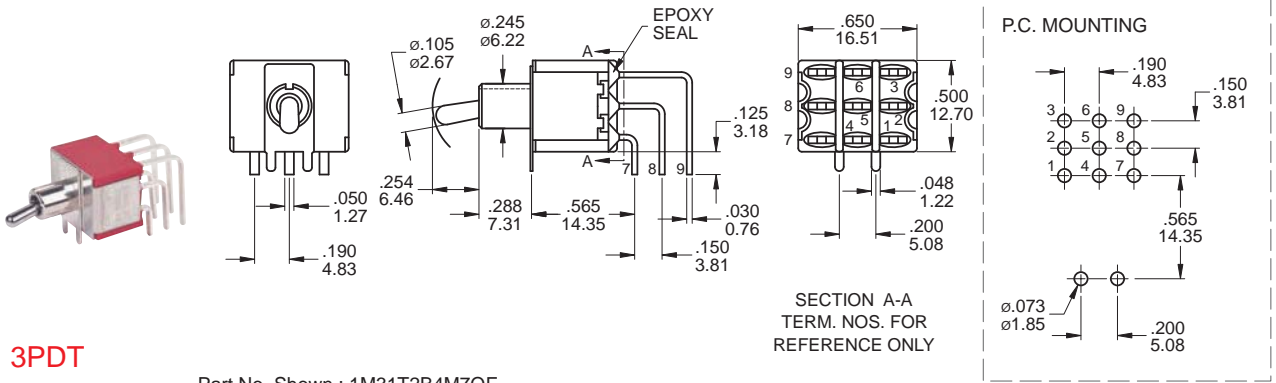

## M7

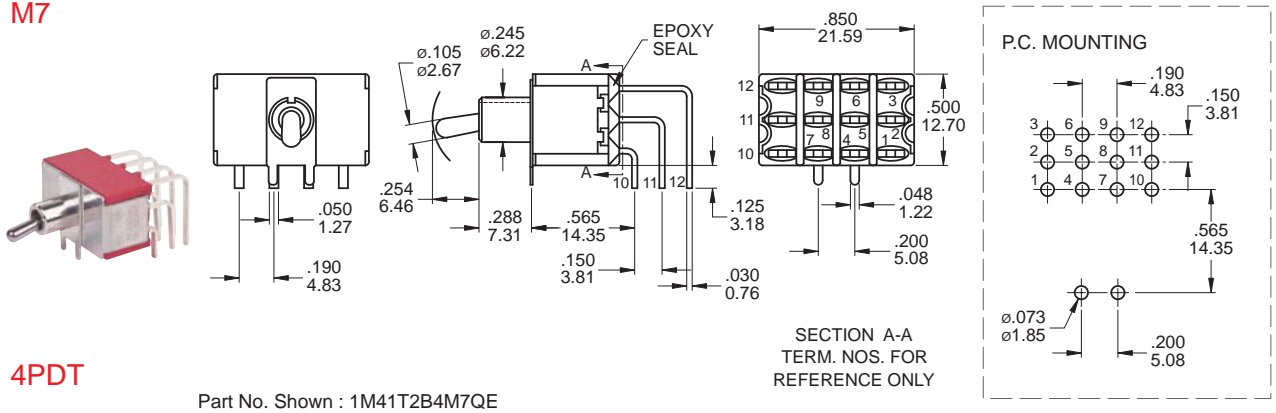

## VS2 - VS3

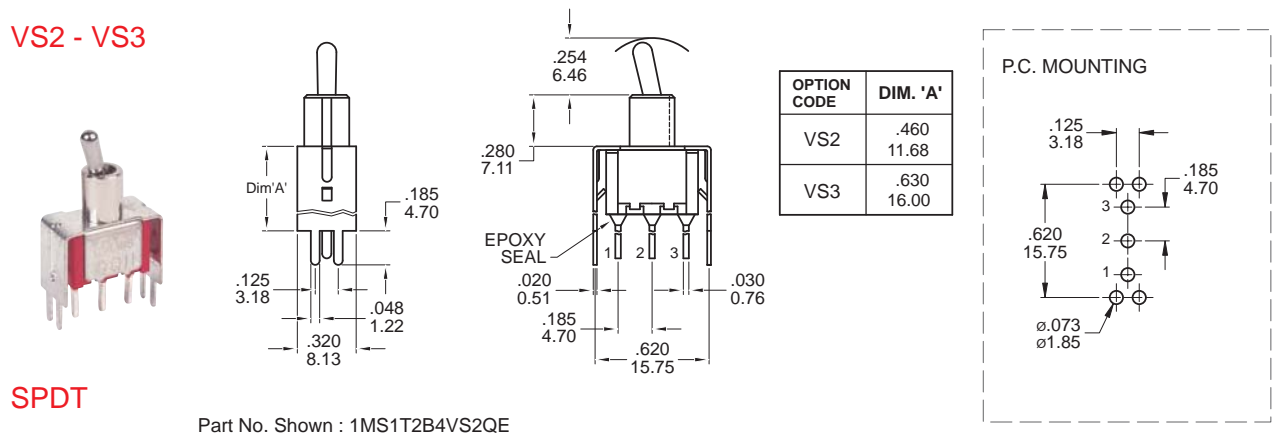

## VS2 - VS3

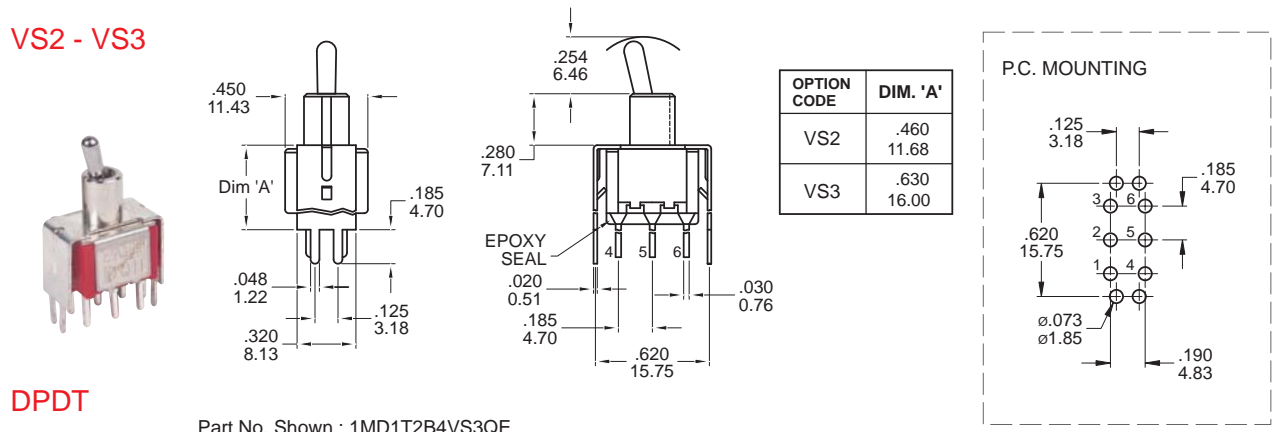

1M  
Toggle Switches



## VS5

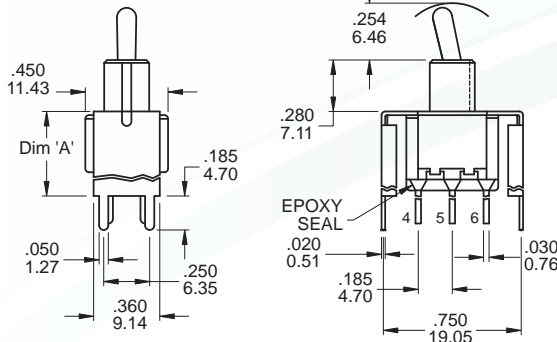

OPTION CODE	DIM. 'A'
VS4	.460 11.68
VS5	.630 16.00

### P.C. MOUNTING

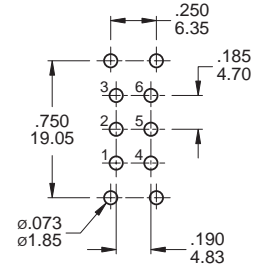

## DPDT

Part No. Shown : 1MD1T2B4VS5QE

## SNAP-IN TERMINATION OPTIONS

### M6N

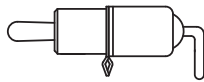

### V2N

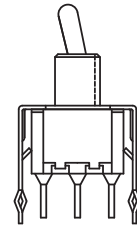

## HARDWARE

### 1/4 NUTS HDW2

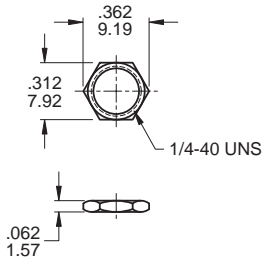

Supplied standard with B1, B3, B5, B6 and B9 options

### DRESS NUT HDW3

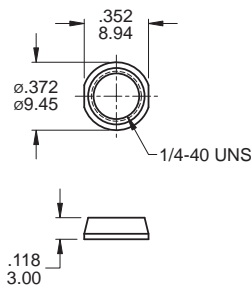

### METRIC NUT HDW6

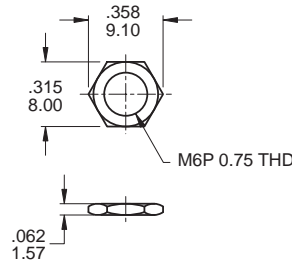

Supplied standard with B8 metric bushing

### LOCK WASHER HDW11

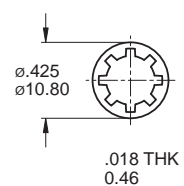

Supplied standard with B1 / B3 bushing

### OPTIONAL RUBBER HOOD SEALING

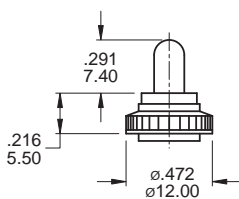

K1=Metric  
E1=Inch (Std.)  
for actuator T1, T2 and  
B1, B3, B5, B6 Bushing only

### 15/32 NUTS HDW4

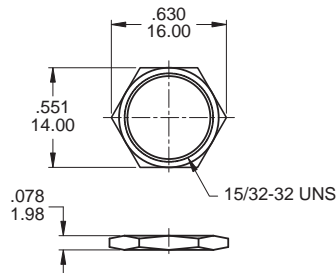

Supplied standard with B13 bushing

### LOCK WASHER HDW12

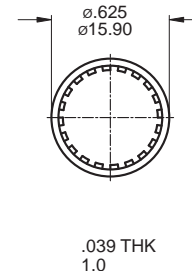

Supplied standard with B13 bushing

## HDW15

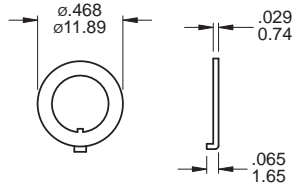

Locking ring supplied standard

## HDW16

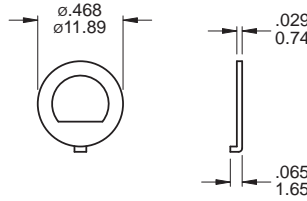

Locking ring supplied with B5 bushing

## HDW17

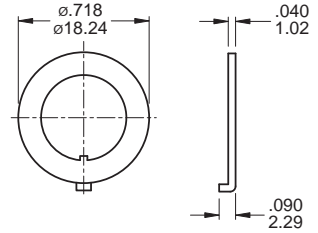

Locking ring supplied with B13,B18,B20 bushing

## HDW18

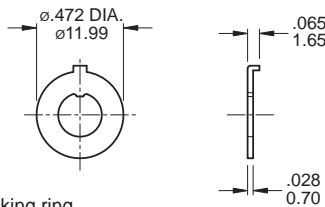

Locking ring supplied with B8 bushing

## HDW19

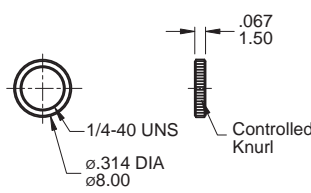

NU-1M18

## HDW20

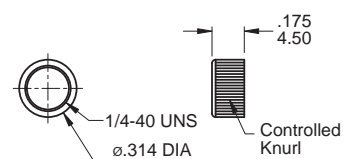

NU-1M24

## OPTIONAL TOGGLE CAP

### CP-T1XX

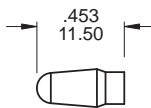

Use with T1

#### CAP Color :

ITEM NO	COLOR
1	White
2	Black (Std)
3	Red
5	Yellow
6	Green
7	Blue
9	Gray

## CONTACT MATERIAL OPTIONS

	CONTACT PLATING	TERMINAL PLATING	RATINGS
<b>Q</b>	Silver	Q = Silver	5 Amps with resistant load @ 120VAC or 28VDC 2 Amps with resistant load @ 250VAC
<b>S</b>		S = Silver,pure - tin	
<b>C</b>	Gold over Silver	C = Gold over silver	
<b>K</b>		K = Gold over silver,pure - tin	
<b>R</b>	Gold	R = Gold	0.4 Volt - Amps ( VA ) max. @ 20V max. ( AC or DC )
<b>G</b>		G = Gold,pure - tin	

## SOLDERING PROCESSES

**MANUAL SOLDERING:** Use soldering iron of 30 watts, controlled at 350°C approximately 5 seconds while applying solder.

**WAVE SOLDERING:** Recommended Soldering Temperature: 260 ± 5°C

Duration of Solder Immersion: Max 5 sec. (PCB is 1.6mm in thickness)