



## SPECIFICATIONS

- RATING** : 100mA max, 42 VAC/DC
- MECHANICAL LIFE** : 1,000,000 cycles
- CONTACT RESISTANCE** : 100mΩ max.(initial)
- INSULATION RESISTANCE** : 1000MΩ min.
- DIELECTRIC STRENGTH** : 1,000 VAC
- FORCE** : 3N±0.75N
- TRAVEL** : 0.6±0.2mm
- OPERATING TEMPERATURE RANG** : -25°C~+70°C

## MATERIALS

- SWITCH HOUSING** : PBT
- TRANSPARENT ACTUATOR** : PC
- ACTUATOR** : ABS
- CONTACT** : Stainless,Au or Ag plated
- TERMINALS** : Brass,Au or Ag plated
- TERMINAL SEAL** : Epoxy



## HOW TO ORDER

MODEL NO.    SIZE TYPE    CAP TYPE    CAP COLOR    LED Q'TY    1st SET LED COLOR (B,C Type Cap Only)    2nd SET LED COLOR (A,D Type Cap Only)    CONTACT MATERIAL    LED BRIGHTNESS

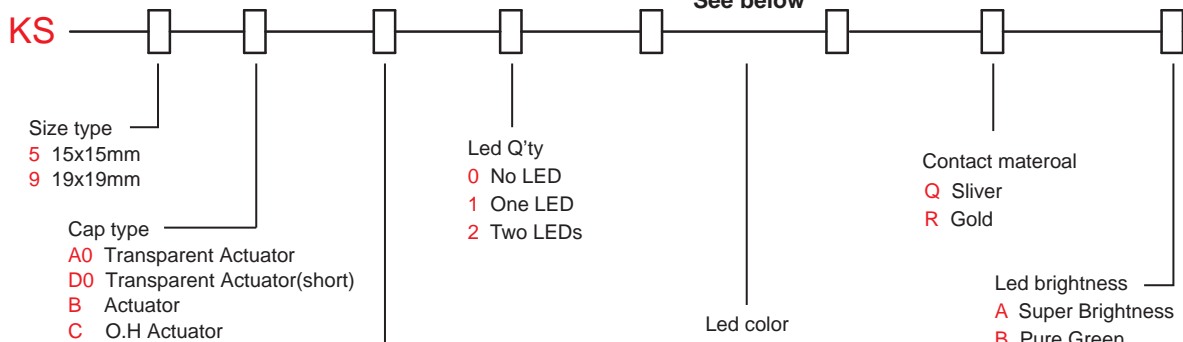

Cap color

ITEM NO	COLOR
1	White (Std)
3	Red (Std)
4	Orange
5	Yellow
6	Green
7	Blue

Led color

ITEM NO	COLOR
0	Without LED
1	White
3	Red
5	Yellow
6	Green
7	Blue
DUAL COLOR LED	
A	Red&Pure Green
B	Yellow&Pure Green

\* Besides standard color, other colors need to check stocks available.

**P.C.B MOUNTING / CIRCUIT**

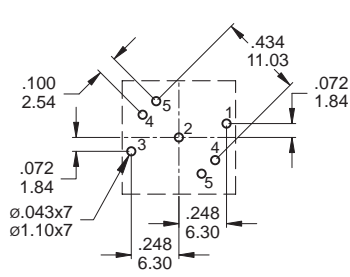

KS5A CAP Type  
TOP VIEW

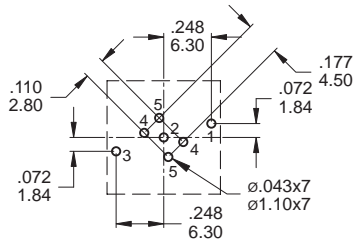

KS5B/C CAP Type  
TOP VIEW

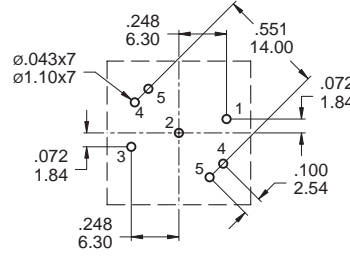

KS9A CAP Type  
TOP VIEW

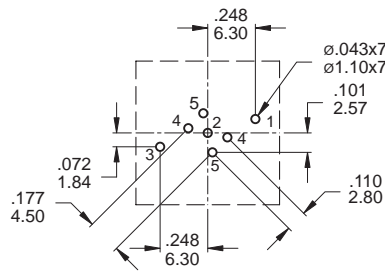

KS9B/C CAP Type  
TOP VIEW

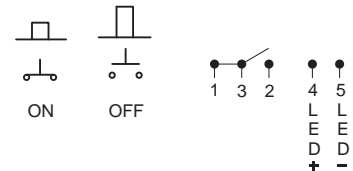

CIRCUIT

**KS5A0**

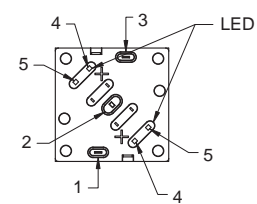
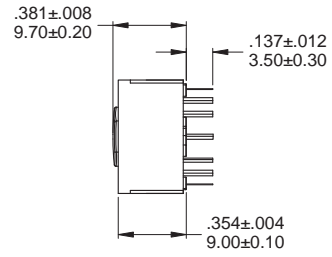
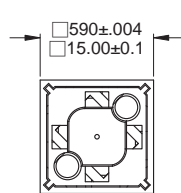

**KS5D0**

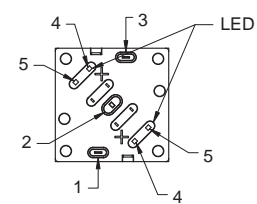
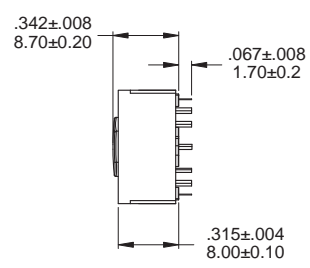
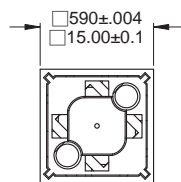

**KS5B**

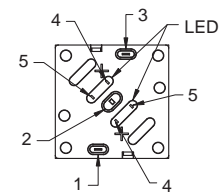
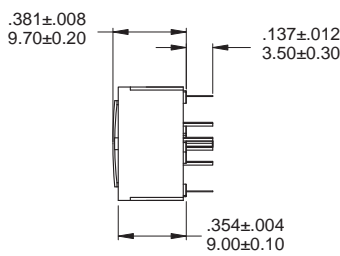
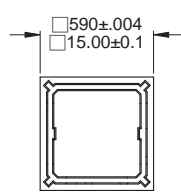

KS  
Tact Switches

## KS5C

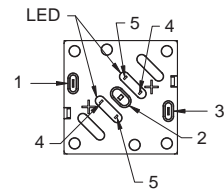
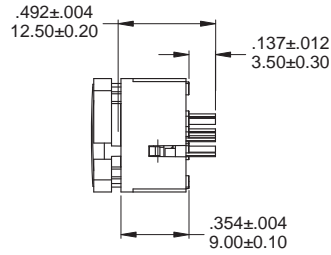
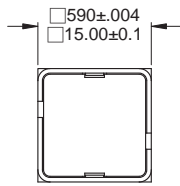

## KS9A

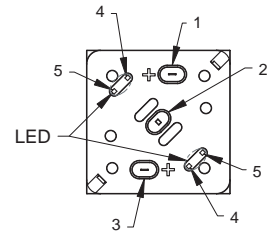
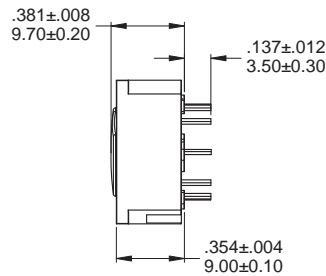
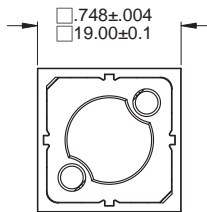

## KS9B

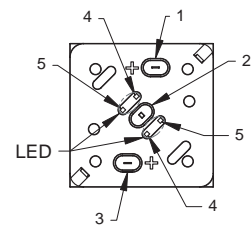
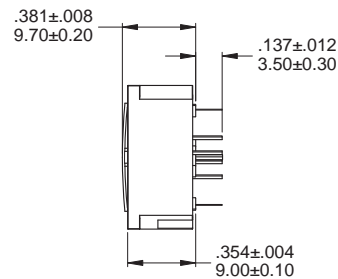
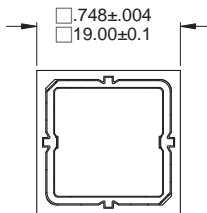

## KS9C

