



## SPECIFICATIONS

**CONTACT RATING:** 0.4 VA max. @ 20 V AC or DC max.

**MECHANICAL LIFE:** 40,000 make-and-break cycles.

**CONTACT RESISTANCE:** **Below** 100 mΩ typ. initial @ 2-4VDC, 100mA.

**INSULATION RESISTANCE:** 500 MΩ min.

**DIELECTRIC STRENGTH:** 500 Vrms min. @ sea level.

**OPERATING TEMPERATURE:** -30°C to 85°C.

## MATERIALS

**HOUSING AND BASE:** Glass filled nylon 6/6 or 4/6 , flame retardant , heat stabilized (UL94V-0)

**ACTUATOR:** Glass filled nylon 6/6 , flame retardant, heat stabilized (UL94V-0), with standard internal o-ring seal.

**SWITCH SUPPORT:** Steel, with Sn plate.

**CONTACTS/TERMINALS:** Gold plated copper alloy.

IP 67  
ACCORDING TO  
EN 60529:1991+A1:2001  
IEC 60529:2001



## HOW TO ORDER

MODEL NO.      ACTUATOR      HOUSING      TERMINATIONS      TERMINAL MATERIAL      SEAL      RoHS SOLDERING

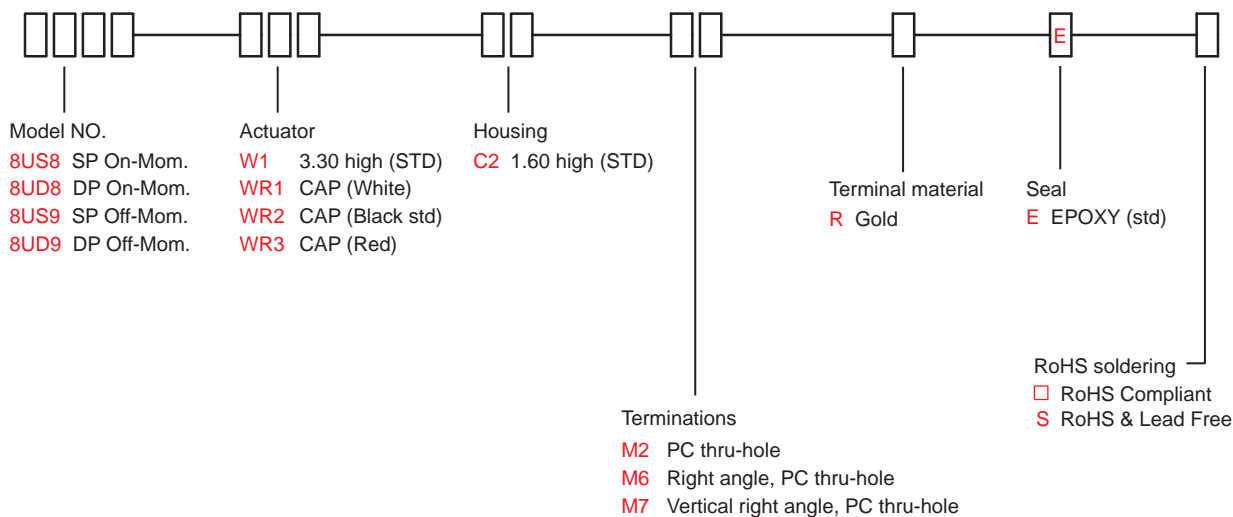

8U  
Pushbutton Switches

# 8U Series

Sealed Ultraminiature Pushbutton Switches

## SWITCH FUNCTION

NO. POLES	MODEL NO.	SWITCH FUNCTION		CONNECTED TERMINALS / SCHEMATIC	
		POS.1	POS.2	POS.1	POS.2
SP	8US8	ON	MOM	5-6 5 (COMM) NC 4 • 6 NO	5-4 5 (COMM) NC 4 • 6 NO
	8US9	OFF	MOM	OPEN	4-6 4 ↑ 6
DP	8UD8	ON	MOM	2-3,5-6 2 (COMM) NC 1 • 3 NO NC 4 • 6 NO	2-1,5-4 2 (COMM) NC 1 • 3 NO NC 4 • 6 NO
	8UD9	OFF	MOM	OPEN	1-3,4-6 1 ↑ 3 4 ↑ 6

MOM=MOMENTARY

## POLE OPTIONS

M2

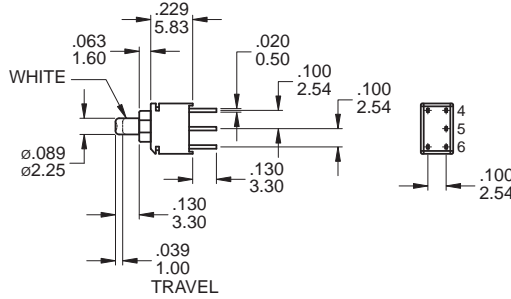
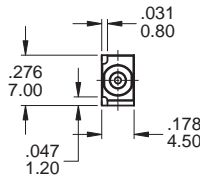

P.C. MOUNTING

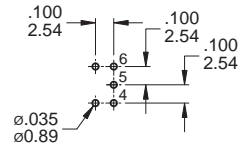

Part No. Shown : 8US8W1C2M2R2E

SPDT

M2

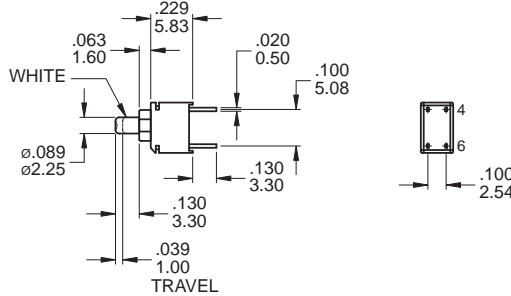
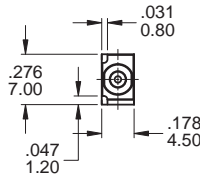

P.C. MOUNTING

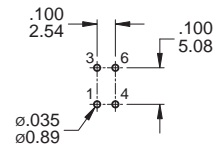

Part No. Shown : 8US9W1C2M2R2E

SPST

M2

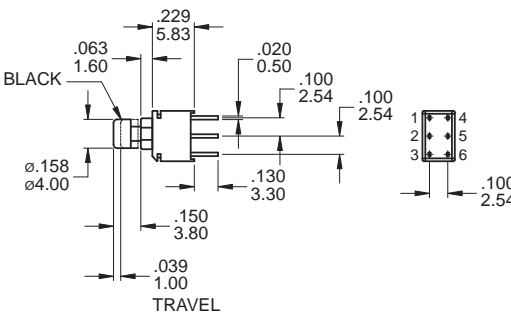
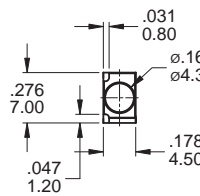

P.C. MOUNTING

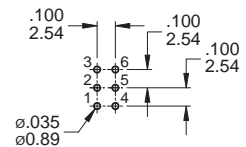

Part No. Shown : 8UD8WR2C2M2R2E

DPDT

M2

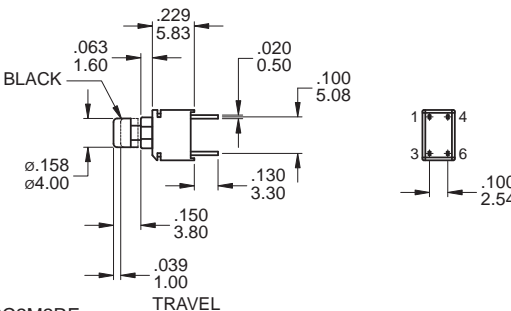
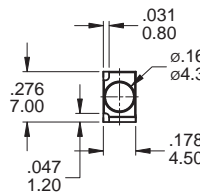

P.C. MOUNTING

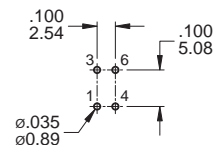

Part No. Shown : 8UD9WR2C2M2R2E

DPST

8U Pushbutton Switches

### M6

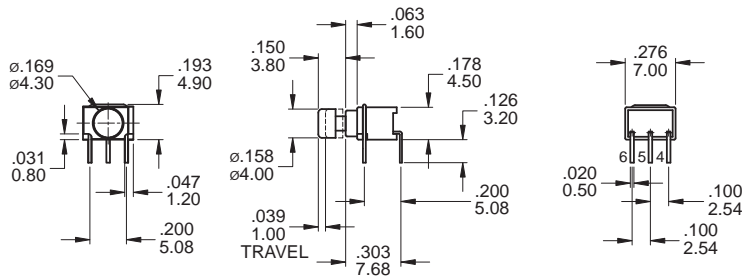

#### P.C. MOUNTING

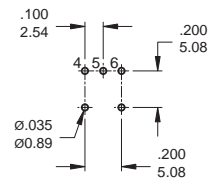

### SPDT

Part No. Shown : 8US8WR2C2M6RE

### M6

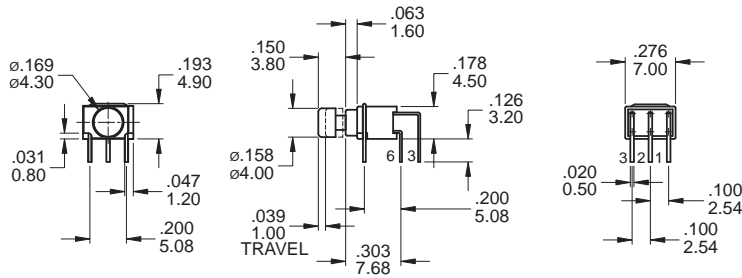

#### P.C. MOUNTING

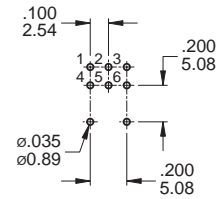

### DPDT

Part No. Shown : 8UD8WR2C2M6RE

### M7

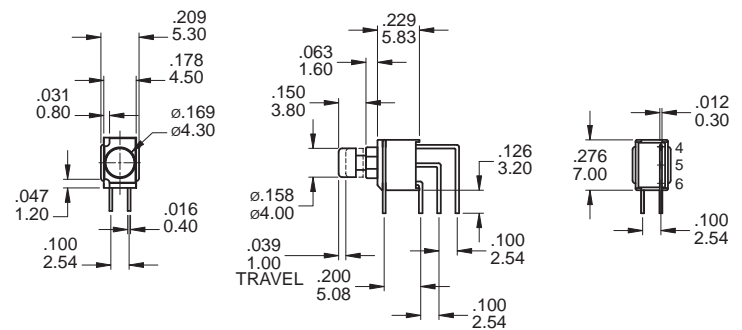

#### P.C. MOUNTING

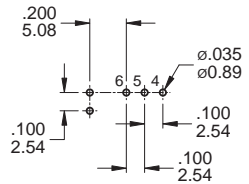

### SPDT

Part No. Shown : 8US8WR2C2M7RE

### M7

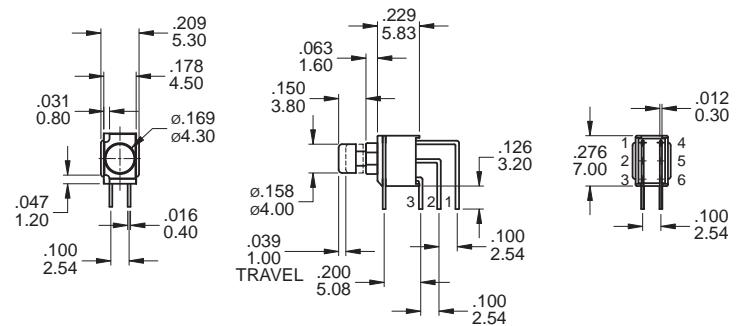

#### P.C. MOUNTING

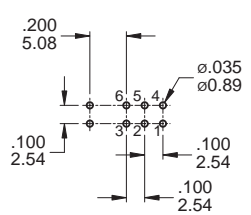

### DPDT

Part No. Shown : 8UD8WR2C2M7RE

## SOLDERING PROCESSES

WAVE SOLDERING: Recommended Soldering Temperature:  $270 \pm 5^\circ\text{C}$

Duration of Solder Immersion: Max 5 sec.(PCB is 1.6mm in thickness)

