

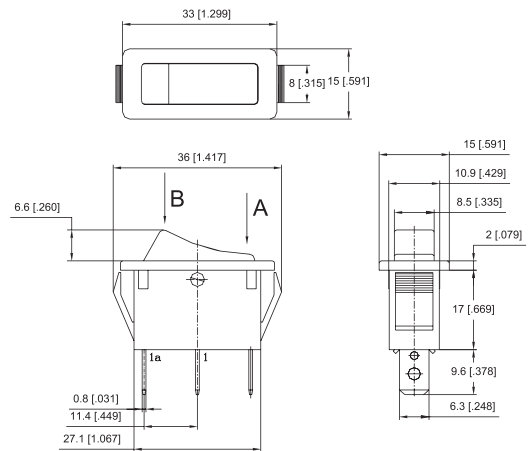

## OPTIONS OF SWITCH FUNCTION / DIMENSION

Item NO	POLES & THROWS	Rocker position ( ):Momentary		
		Left	Center	Right
R41	SPST	ON	None	OFF
R42	SPDT	ON	None	ON
R43	SPDT	ON	OFF	ON
R44	SPDT	ON	None	(ON)
R45	SPST	OFF	None	(ON)
R46	SPDT	(ON)	OFF	(ON)
R47	SPST	ON	None	(OFF)
R48	SPDT	ON	OFF	(ON)
R49	SPST (WITHLAMP)	ON	None	OFF



## PANEL CUT OUT

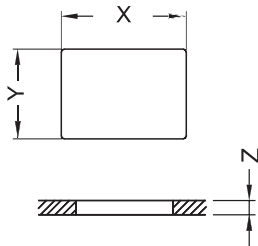

Z	Y	X
0.70~1.25	11.10~11.20	29.60~29.70
1.25~2.00	11.10~11.20	30.10~30.20
2.00~3.00	11.10~11.20	30.45~30.55

## CIRCUITS FOR SWITCH WITH LAMP

For circuit of 250V AC or 125V AC  
For circuit of 24V DC or 12V DC

