

## Thermal Link HL Series

## 10A Series

### Key Features

- Plastic case
- Non-resettable
- High accuracy of function temperature
- High operating voltage
- RoHS & REACH compliant

### Customization

- Other temperature can be customized
- The length of lead wires can be customized as required

### Dimensions

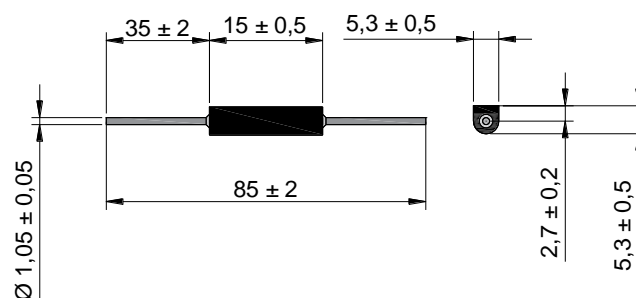

### Spezifikation

Model	$T_f$	Fusing Temp.	$T_h$	$T_m$	$I_r$	$U_r$	$I_n$ 8/20 $\mu$ s (15 Times)	$I_{max}$ 8/20 $\mu$ s (1 Time)	
	(°C)	(°C)	(°C)	(°C)	(A)	(V)	(kA)	(kA)	
HL0	76	73±2	43	200	10	AC 800	3	6	●
HL18	86	81±2	51	200	10	AC 800	3	6	●
HL1	102	98±2	72	200	10	AC 800	4	8	●
HL2	115	111±2	85	200	10	AC 800	4	8	●
HL3	125	121±2	95	200	10	AC 800	4	8	●
HL4	130	125±2	100	200	10	AC 800	4	8	●
HL5	135	130±2	105	200	10	AC 800	4	8	●
HL6	145	140±2	115	200	10	AC 800	4	8	●
HL7	150	145±2	120	200	10	AC 800	4	8	●